

The technical data are subject to change without notice. The product pictures are for reference only. Please refer to the real object finally. The company reserves the right to change and explain.



INSTRUCTIONS



ALTO Garden, LLC

TELEPHONE: +1-818-940-1140

E-mail: contact@altogarden.com

WEB: www.altogarden.com

CONTENTS

I

HYDRO TOWER ASSEMBLY GUIDE

TOWER COMPONENTS 02

TOWER ASSEMBLY 03

II

HYDRO TOWER GROWING GUIDE

STARTING YOUR SEEDS 07

PLANTING GREENS 08

VEGETABLES FOR BEGINNERS 09

FILLING RESERVOIR AND ADDING NUTRIENTS 10

ADDING WATER TO YOUR TOWER 10

DRAINING AND REFILLING THE RESERVOIR 11

CLEANUP AND STORAGE 11

MAINTAINING YOUR HYDROPONIC TOWER 12

TROUBLE SHOOTING 13

HYDRO TOWER ASSEMBLY GUIDE

TOWER COMPONENTS



Reservoir Base



Reservoir Lid



Tower Sections (x6)



Shower Cap & Lid



Observation Lid



Wingnuts (x6),
Washers



Gasket(x3)



Water Pump



Swivel Hose



Water Monitor



Rod (x4)



Connecting Nut (x2)

GROWING & MAINTENANCE



Germination Tray



Rockwool Cubes



Net Pots

LED GROW LIGHT KIT(optional)



(Arrives in one of the
six Tower Sections.
Gently pull out.)



LED
Lamps (x8)

TOWER ASSEMBLY

1



ALTO Garden
YouTube Channel



Search Channel for
GX Assembly Video

2



Tie loop to prevent
water from running
down cord to outlet

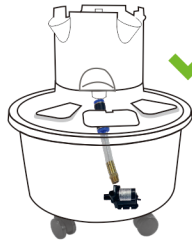

DO NOT plug in pump
until assembly is complete
and reservoir has been filled



Use GFCI outlet when
plugging in.

3



23 in.

Place one gasket inside bottom of 1st
tower section, place second gasket
underneath reservoir lid.

Feed rods through each side of both
gaskets, secure two gaskets together
with wingnuts. This secures 1st tower
section to the reservoir lid.

ASSEMBLY GUIDE

4

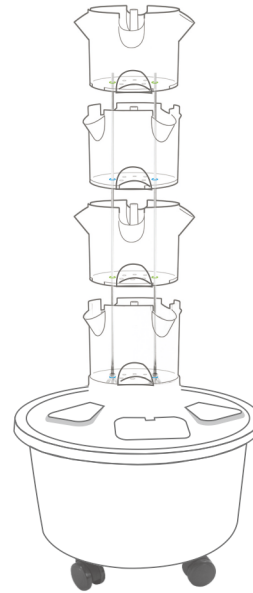

5



6

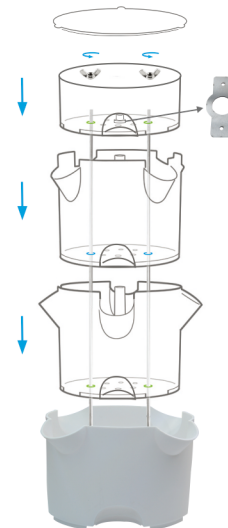

7



8

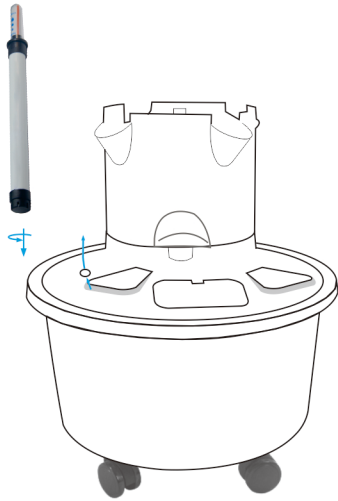

9



10

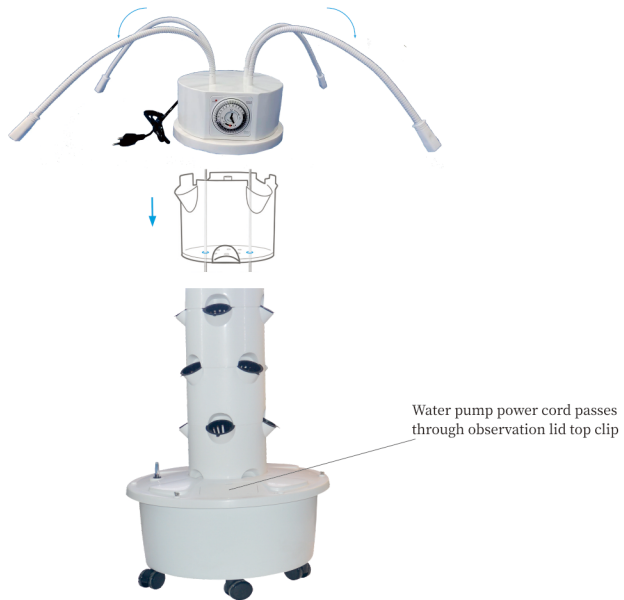

11



x8

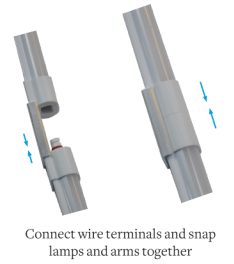

12

If light doesn't turn on, uninstall light and turn it around, reversing the connections. Re-install.



HYDRO TOWER GROWING GUIDE

STARTING YOUR SEEDS

- PLACE** seeds into cube openings:
Please refer to each individual seed packet for the number of seeds needed for each plant.



ALTO Garden
YouTube Channel



Search Channel for
Germination Video

- SPRINKLE** each hole with water, and add about 1/4 inch water to bottom of tray. Water PH 5.5–6.5.



- PLACE** in sun or under grow light* (if you don't have an adequate source of sunlight) and water as needed to maintain 1/4-inch of moisture.

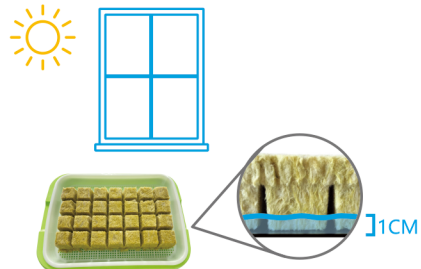

*If using a grow light, place 8" above seedlings and keep light on for 18 hours/day.

- WATER** as needed until seedlings are fully sprouted and healthy—about 1–3 weeks.

Regular Greens

When your seedlings are about two inches tall and have roots protruding from the bottom of the rockwool cubes, it's time to transplant.

Baby Greens

When seeds have sprouted, it's time to transplant.



PLANTING GREENS

5 A. Regular Greens

TRANSPLANT seedlings to hydroponic tower by placing one cube inside each net pot, gently pressing until cube touches the pot base.

Important: Cube must be touching base to receive proper water and nutrients.



DID YOU KNOW...?

Hydroponic tower will also work with pre-sprouted seedlings purchased from market—a great option for plants that take longer to germinate.

VEGETABLES FOR BEGINNERS

Delicious baby greens we recommend for beginners:

- ★ Kale
- ★ Arugula
- ★ Mild mix
- ★ Spicy mix
- ★ Red-veined Sorrel
- ★ Garnet red Amaranth
- ★ Ruby red orach Amaranth
- ★ Scarlet frills mustard
- ★ Stir fry mix
- ★ Wrinkled crinkled cress
- ★ Salanova lettuce
- ★ Most salad mixes
- ★ Most spicy green mixes



Our baby greens planter is also great for growing cooking herbs, such as:

- ★ Chives
- ★ Green onion
- ★ Parsley
- ★ Cilantro
- ★ Cooking greens
- ★ Stir fry mix

FILLING RESERVOIR AND ADDING NUTRIENTS

- 1 Your hydroponic tower will hold approximately 10 gallons when filled. Fill the reservoir with cool water. Do not overfill the reservoir. NEVER use softened water, heavily chlorinated water, or very hard water, as it may damage your plants. (If you have hardwood floors or carpet, we recommend placing a mat under the reservoir before filling it.)
- 2 Following label instructions for mixing, add Mineral Blends A & B .
- 3 Use a spoon or other utensil to stir in the nutrients thoroughly. Do not use your hands, as the solution may be slightly acidic or alkaline and can irritate the skin.
- 4 Use the pH tester kit to test the pH of the solution in the nutrient reservoir. The optimal pH is 5.5 to 6.5. Adjust to desired pH level.
- 5 Plug in the pump. Check that water is flowing out of the top of the hydroponic tower before putting the light base or tower cover on top.
- 6 Your hydroponic tower functions best if the watering is on a cycle, rather than a continuous flow. For indoor growing, we recommend a 15 minute water cycle every hour for 14 hours a day. Adjust watering schedule as needed.
- 7 Place the access port lid on the reservoir lid.

ADDING WATER TO YOUR TOWER

- 1 Check the water monitor regularly — if the red scale reaches the bottom, it needs to be replenished immediately.
- 2 Add nutrients to the water every time you fill your reservoir tank. You can mix water and the Mineral Blend in a bucket prior to adding it to the reservoir.

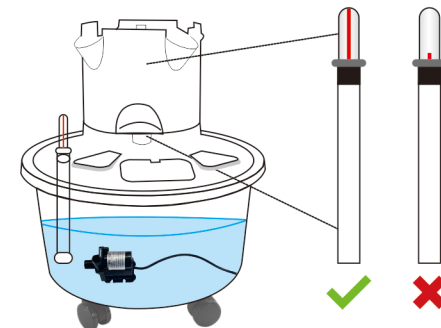

DRAINING AND REFILLING THE RESERVOIR

- 1 Unplug pump and LED lighting kit.
- 2 Remove the screws on the water tank.
- 3 Move the tower aside.
- 4 Remove the water.
- 5 You can use the drained nutrient solution to water landscape plants around your yard.
- 6 Refill the reservoir with fresh water and nutrients.

CLEANUP AND STORAGE

- 1 Remove the plants from the hydroponic tower by pulling the net pots from the planting holes.
- 2 Disassemble the tower sections, starting at the top. Do not remove the bottom section from the reservoir lid.
- 3 Unscrew the swivel hose from the reservoir lid and pump. Rinse pump with clean water before storage.
- 4 After cleaning the tower sections, you can store the parts of the hydroponic tower in the reservoir until you are ready to grow nutritious greens and herbs again.

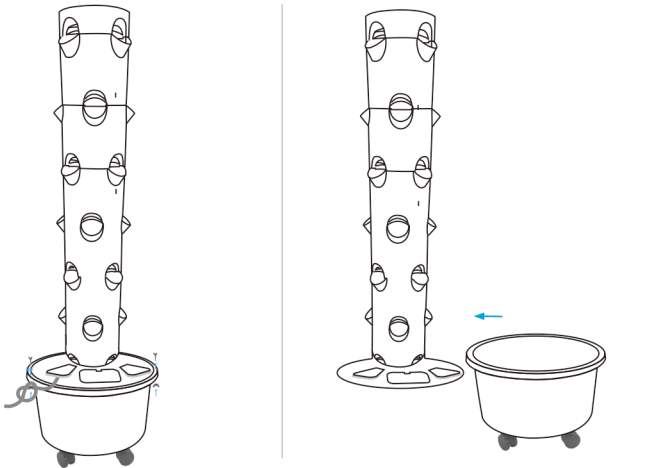

Because water can drip from plants when harvesting or when draining and refilling your hydroponic tower, we recommend placing a waterproof mat under the reservoir to protect your carpet and floors.

MAINTAINING YOUR HYDROPONIC TOWER

DAILY

- ★ Check water level. See [ADDING WATER TO YOUR HYDROPONIC TOWER](#) to ensure correct level.

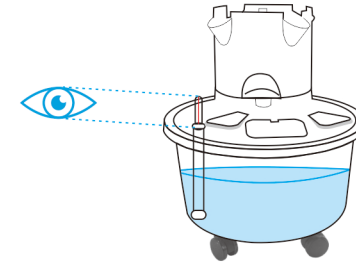

WEEKLY

- ★ Check the pH weekly and after refilling the reservoir, follow the instructions to adjust your pH level. Yellowing leaves are an indication that your pH may have drifted out of the recommended range.
- ★ Keep roots away from the pump. You should trim the roots that may be dangling in the reservoir.



MONTHLY

- ★ Keep the shower cap holes clean and free from debris. You can use a toothpick to clean the holes.
- ★ Clean the pump monthly. Unplug the pump, pull the pump up through the access port and remove the pump cover. Clean with water to remove debris.



SEMIANNUALLY

- ★ After disassembling, clean the tower sections, shower cap and lid, and the pump with warm soapy water and a sponge.

TROUBLE SHOOTING

Little or no water flowing out of the shower cap

- ★ Make sure pump is plugged in.
- ★ Make sure the outlet has not tripped the GFI or indoor breaker switch.
- ★ Check for a clogged pump and clean, if necessary.
- ★ Check for a kink in the swivel hose.
- ★ Make sure swivel hose is firmly connected to the water pump.
- ★ Unplug and replug the pump from the electrical outlet. Magnetic pumps sometimes need to be restarted after long periods of continuous operation.

Algae buildup in the reservoir and shower cap

- ★ Light is getting into the system. Make sure all lids are secure and tight.

Water leaks from around net pot

- ★ Make sure your hydroponic tower is level.
- ★ With seedlings and small plants, rotate the net pot in either direction to dislodge any object that may be causing the leak.

Shower cap is running over

- ★ Use a toothpick to clean out the shower cap's holes and clear any clogs.

Leaves look yellow

- ★ Make sure the pH is between 5.5 and 6.5. High pH will cause leaves to turn yellow.
- ★ Add Mineral Blend as recommended on bottle labels to ensure nutrient levels are sufficient.

LED lamp does not snap into place on the fixture base.

- ★ If the lamp base does not easily fit on top of the tower, rotate the lamp base around the tower until it fits in place.
- ★ Ensure wires are not pinched between base and lamp.

LED lamp does not work or stops working.

- ★ If light doesn't turn on, uninstall light and turn it around, reversing the connections. Re-install.
- ★ Remove lamp and check that wire terminals are securely connected.
- ★ Remove lamp from base and attach to different base to determine if it is the base or the lamp. Contact our Customer Support team to report the issue.



ALTO Garden - YouTube

www.youtube.com